

## Plans and layout of the synagogue in Olkusz

The plans and layout of the synagogue in Olkusz were prepared at the turn of the 1950s and 1960s by engineer Henryk Straszak (1925–1997). We are deeply grateful to Mrs. Elżbieta Straszak for providing the drawings from her private archive.

See additional information about the synagogue demolished in (possibly) 1957:

<https://sztetl.org.pl/en/towns/o/321-olkusz/112-synagogues-houses-of-prayer-and-others/87485-synagogue>

[https://biblioteka.olkusz.pl/phocadownloadpap/Ilcusiana/ilcusiana\\_15.pdf](https://biblioteka.olkusz.pl/phocadownloadpap/Ilcusiana/ilcusiana_15.pdf) (page 63; in Polish)

and the synnagoge picture after the second war (from the Regional Museum PTTK in Olkusz):



# Zdjęcie inwentaryzacyjne

Synagogi i położonego obok bud. mieszk.,  
znajdujących się na parceli w Olkuszu  
pomiędzy ul. Górniczą i Bóżniczą

Plan sytuacyjny 1:250

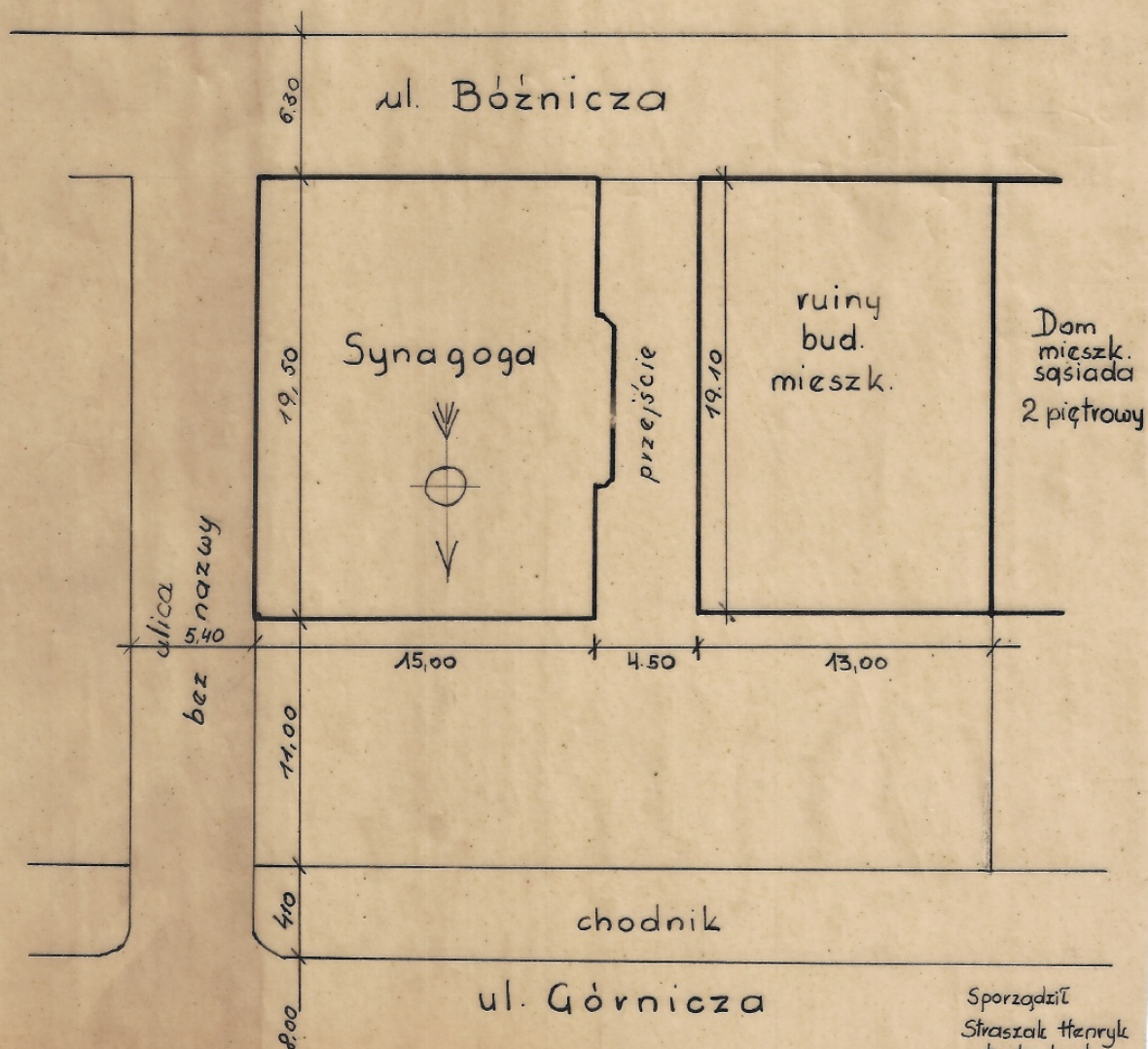

Sporządził  
Straszak Henryk  
techn. bud.



Translation of the figure description by ChatGPT. Corrections: put "a street without a name" instead of "Ulicz Steen"; see buildings orientations at the original drawing.

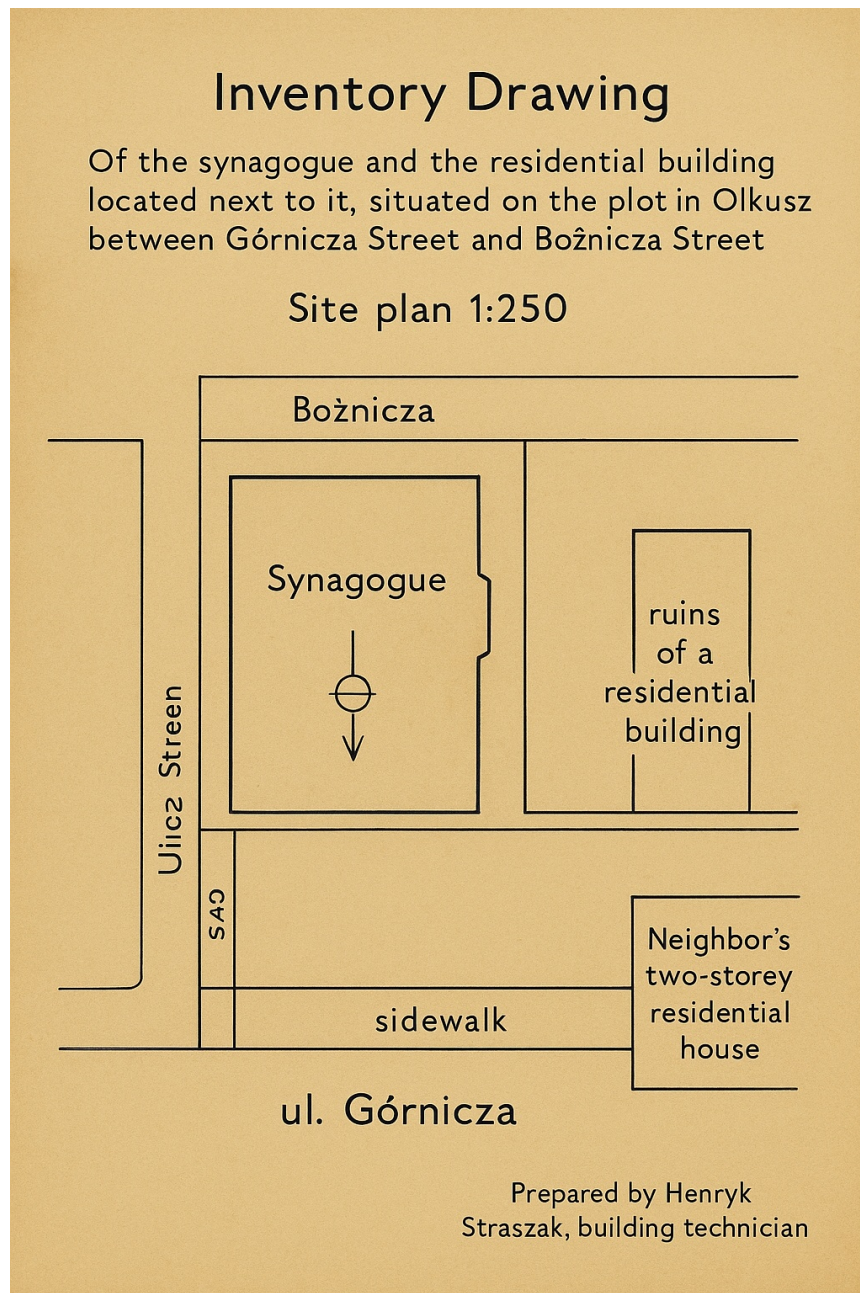



Architectural floor plan of a two-story residential building. The plan includes detailed dimensions for all walls, openings, and structural elements. Key features include:

- Overall Dimensions:** Total width 1950, total depth 1300.
- Structural Annotations:** "mur zburzony" (damaged wall) is noted on the left and right sides.
- Room Layout:** The plan shows a central corridor, multiple rooms, and a staircase. Specific room dimensions are provided, such as 1660 x 1020 for the main hall and 1910 x 445 for the rear section.
- Dimensions:** Numerous numerical values are present, indicating wall thicknesses, room widths, and overall building measurements. For example, the main hall is 1660 wide and 1020 deep, while the rear section is 1910 wide and 445 deep.
- Orientation:** A north arrow is located in the upper right corner, pointing towards the top of the page.

Rzut przyziemia 1:100

Ground floor 1:100







